

EXISTING GROUND FLOOR (post 1977 partitioning)

A/04
 Workshop area 289 sq m
 Ancillary uses area 363 sq m
 1977 construction 107 sq m
 Total internal floor area 653 sq m

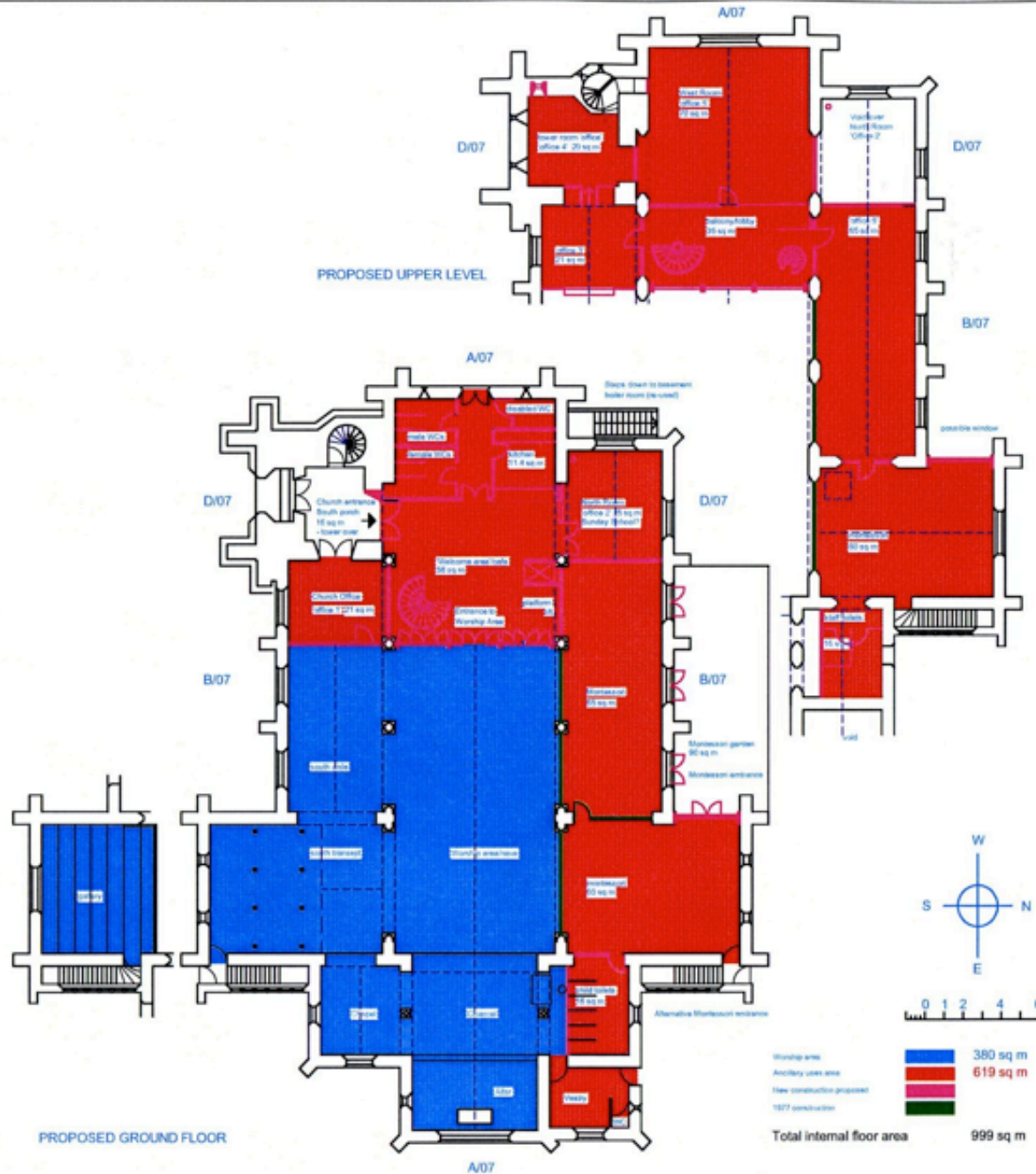

PROPOSED GROUND FLOOR

A/07
 Workshop area 380 sq m
 Ancillary uses area 619 sq m
 New construction proposed 107 sq m
 1977 construction 107 sq m
 Total internal floor area 999 sq m

NOTES
 1. The survey information contained in this drawing has been prepared to illustrate this project only and cannot be regarded as complete or accurate for any other purpose.
 2. This drawing is copyright ©, and may not be reproduced by any means or in any medium without the written authority of the architects.
 3. The project illustrated is preliminary and cannot be assumed to be in compliance with any statutory, mechanical, or structural requirements. The drawing is not to be used as a basis for construction.

Revisions	
Rev A 28/06/09	Ancillary areas hatched. Gallery shown on proposed plan
Rev B 3/09/09	Areas added. Montessori void omitted

Project:
 St Andrews Church
 Thornhill Sq London N1 -
 Proposed Reordering
 Drawing title:
 Plans as proposed and
 existing - Scheme A2
 Scale: Date:
 1:250 @ A3 13 Aug 2009
 Drawn by:
 JID

James Dunnnett Architects
 142 Barnsbury Road,
 London N1 0ER
 Tel 020 7833 3451
 Fax 020 7833 2126
 e-mail jidunnnett@aol.com
 Drawing no.
 0501/SK11
 Rev.
 B